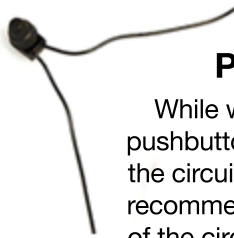
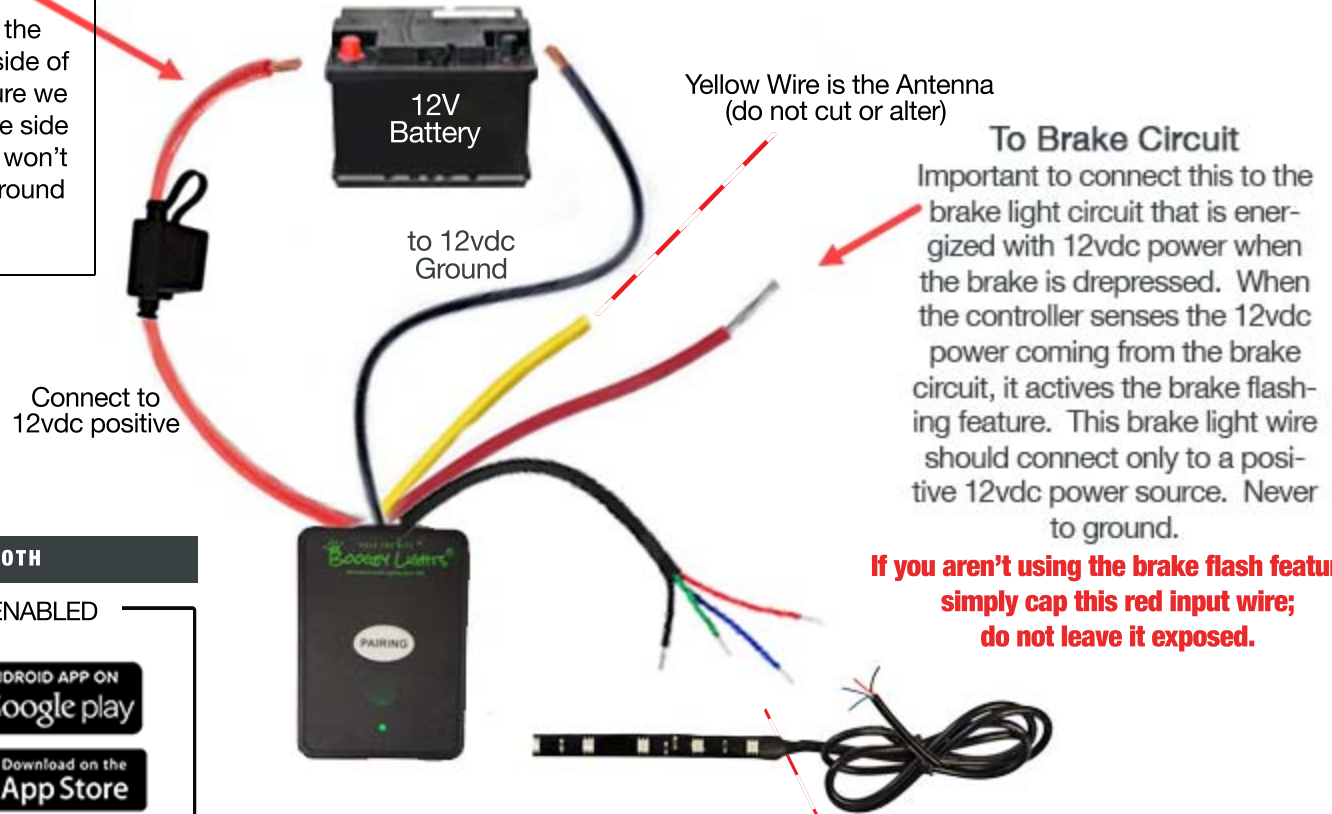

# Multi-Color Wireless LED Controller with Brake Light Circuit Wiring Diagram

**(Optional) Pushbutton Switch**

While we normally prefer to place the pushbutton switch on the negative side of the circuit, with the brake flash feature we recommend placing it on the positive side of the circuit. Some newer vehicles won't work correctly if there isn't a solid ground at all times on the controller.

**AVAILABLE IN EITHER RF KEYFOBS or BLUETOOTH**

**RF REMOTE CONTROL**



Remote Control KEY FOBs

**BLUETOOTH ENABLED**



Download the **FREE Boogey Lights APP** from APP store.

Download the APP operating manual from [www.BoogeyLights.com](http://www.BoogeyLights.com)

**LED Strip Blue, Red, Green & Black Wires**  
Connects w/ Red, Green, Blue and Black Wires from Controller. Each wire represents its respective light color. BLACK is the GROUND wire.

800.847.1359



[BLMCBF 10-08-21]

[www.BoogeyLights.com](http://www.BoogeyLights.com)