

INSTALLATION GUIDE

KENWORTH W900 EXHAUST STACK BACKLIGHT KIT



Family Owned Motorsports Lighting Since 1989

800.847.1359

www.BoogeyLights.com

Thank you for purchasing genuine Boogey Lights® LED Lighting products! We know you're anxious to get started but we strongly recommend taking time to read through these instructions. You'll likely save yourself some grief and aggravation if you do. For additional installation support refer to www.BoogeyLights.com or give us a call at 800.847.1359 for assistance.

BEFORE YOU START

It's simply not possible to provide detailed instructions for all installation scenarios. Far too many variables and truck variations. **The information in this manual is intended to be used as a guide.** It is not a detailed step-by-step how-to installation manual. We do not spell out every single step along the way. The photos we include may not precisely match your truck. We cover the essential steps related to installing this kit. Beyond that however we must assume the installer has the skills, knowledge and tools necessary to do the work using the information we provide. You may need to vary your installation slightly based on your truck. This is particularly the case with electrical wire routing and switching. If you're unsure about how to do the installation – particularly the electrical components – we urge you to seek assistance from someone who has those skills.

Make sure you have ample area in which to work and that the area is protected from rain or cold temperatures. The 3M adhesive tape (and 3M Adhesion Promoter) works best if applied when the air temperature is above 40 degrees (and of course is DRY).

Bench test your setup. We know this takes a few extra minutes but we STRONGLY suggest you bench test your lights (and LED controller if purchased) on a table before doing anything further. While we test every light strip and controller before shipping, bench testing your lights will eliminate the possibility of any problems with the lights or controller before mounting. Also, the process of bench testing gives you an opportunity to understand the wiring system without interference from other wires, connectors and cables. You can use any 12vdc battery to do this (e.g. car battery, motorcycle battery, lawn tractor battery or 12vdc power supply). Bench testing takes an extra 10 or 15 minutes. It's simple to do and can potentially save you hours of time and frustration down the road. **Please take our advice.** Bench test your LEDs AND controller before mounting.

Tools You'll Likely Need

Sockets/wrenches in the sizes necessary to remove the exhaust stack heat shields on both sides of the truck. There are 6 bolts for each. You'll also need to remove the driver's side steps to access the battery bank, drill, drill bit, wire cutters/strippers, crimping tool, electrical tape, rubbing alcohol, shop rag or two, ladder to reach the top mounting bracket for each stack. You'll also need a heat gun or hair dryer for the heat shrink.

RGB/MULTI-COLOR KIT Installations: Installation of this led light kit takes 2 to 4 hours depending on whether or not you're adding this light kit to an existing installation or installing this kit as a stand-alone. If the LED Controller is already installed with another kit (e.g. Under-Glow), this kit will simply tie into that controller. If you need to also install the LED Controller, it will take additional time to do this. Wiring diagram is included at the end of the guide.

SINGLE / DUAL-COLOR KIT Installations: Installation of our single color kit typically takes 2 to 3 hours. With single color installations we always recommend using a dedicated on/off switch OR if you want to tie them into an existing circuit (e.g. marker lights), we suggest adding a relay to the circuit. If you purchased the on/off wireless switch we offer, you do not need a relay provided the breather lights in this kit are the only lights you're switching on it.

Mounting Locations

Each exhaust stack has two led strips; one on each side of the stack and facing outward. See photos for placement. The led strips are mounted to plastic L-Channel which is included. That L-Channel is either bolted to or riveted to the stack's shield three mounting brackets (which are secured to each exhaust stack). Because those shield mounting brackets may need to be removed from the truck to service the exhaust stacks, we include 2 M/F pairs of quick-disconnect connectors with this kit. Each stack has one quick-disconnect. Both LED strips on the stack come together at the bottom of the stack to use one quick-disconnect.

If you're installing an LED controller (or wireless on/off switch) with this kit, you'll need to remove the driver's side steps to access the batteries. You can mount it anywhere you have a dry area. We prefer to mount our led controllers in either the driver's or passenger's side storage box but it's not required. You can just as easily mount the controller in the engine compartment or also inside the battery box. The key is making sure you're mounting it where it is protected from water or extreme heat. There should be air flow too around the controller. If mounting inside either of the storage boxes, you will need to drill a hole in the floor of that box to connect power to the battery box, led wires and antenna. We provide some butyl tape to seal this hole.

We include photos of the installation at the end of this guide. The photos are of the passenger's side of the truck. You'll need to repeat the process for the driver's side stack.

What You Need to Know

In putting together this installation guide we assume the installer has access to and has a basic understanding of using the tools needed to complete this installation. We also assume the following:

- The installer knows how to remove the exhaust stack heat shields from the truck. There are 6 bolts (and nuts) for each shield.
- The installer knows how to remove the truck's driver side steps to access the batteries.
- The installer understands 12vdc electricity, the importance of not overloading a circuit, making electrical connections using crimp on connectors, the importance of having a fuse in the circuit at the battery location and polarity.
- How to access the batteries, remove / connect battery connections, how to make electrical connections (e.g. crimping) and the importance of making sure all electrical connections are sealed properly (e.g. no water intrusion).
- How to run power lead cabling such that the power leads and related wiring are secured in a way as to protect them from chafing, pinching or melting because they're too close to the engine or other extreme heat source.

WHAT'S INCLUDED

In addition to the LED light strips, power leads, quick-disconnects (and controller / switch if ordered), this kit includes some additional items you'll need. Here's a quick review of those items and why we include them. Some of the photos at the end of this guide reference these items too.

- Four, 48" plastic L-Channel. Two for each stack. See photos for placement mounting.
- 18AWG or 20AWG Feeder Cable – 4 Conductor for RGB, 2 Conductor for Single Color. Use this cable to extend the LED power leads back to the battery box and/or the LED controller/switch.
- 3M Adhesion Primer. Used to prep the surface before attaching the LED strips AND the 3M quick-lock tape. *Always, always, always* use this adhesion primer with 3M adhesive products if you want the bond to hold.
- 3M Quick Lock Reclosable Tape. This is a heavy duty "Velcro like" product. Used to mount the LED controller (if purchased) to the wall in the storage compartment or similar location.
- Split Wire Loom / ¼". All power leads and the battery extension cables need to be protected from chaffing. Wrap them in this first.
- Split Wire Loom / ½" . We include the ½" split wire loom to be used when you're connecting multiple power leads together. Helps protect that connection.
- Heat shrink. 1/8" and ½". Use this heat shrink to make and seal your quick-disconnect connections. Use the 1/8" to cover each of the power lead connections to the connector. Then, use the ½" to cover that group. See photo. You'll have to do this for both breathers.
- Battery Extension Cable (if LED Controller is purchased). We include some 12awg cable to extend the battery power inputs going to the LED Controller to the battery. Be sure to wrap this extension cable in split loom.
- Fuse Holder – 25AMP (if LED Controller is purchased). Insert this fuse holder on the 12vdc positive side of the battery connection before the battery extension cable. This is critical.
- Battery Terminal Lugs (if LED Controller is purchased). We include a couple of battery terminal lugs that attach to the battery extension cable (crimp on) to make it easy to connect the positive and negative power leads to the truck's battery to the LED controller. It's a much better way to make this connection than to just simply wrap the bare cable around the battery post.
- Butyl Tape. We use butyl tape in a number of places to secure the LED lights to the inside of the breather (see photo) as well as to seal up any holes drilled in the truck. Butyl will only work if you apply it to a clean surface so make sure you first clean the surface with rubbing alcohol.
- 8" Zip Ties. We include some zip ties which you'll need to secure the LED power leads to the truck.
- Crimp On Wire Connectors. These are used to secure the wire connectors at the LED Controller as well as making all power lead connectors to the feeder cable. We recommend wrapping each connector after it's crimped with electrical tape to protect it from water intrusion.

NOTE: Every installation varies a little so you may need to purchase additional items (or more of them such as zip ties) for your install.

CUTTING YOUR LEDS- While you shouldn't have to do so, if you need to cut your LED strip you can do so as long as you cut in the proper location – which is every three LEDs as shown in the below photo. Cutting incorrectly could damage your lights and is not covered by the warranty. If you cut the strip, be sure to use the included heat shrink tubing to seal the cut end. You can also use silicone found at your local hardware or RV store. If you do need to cut your LED strip, we strongly suggest doing so BEFORE you mount the strip.



Cut Locations

Follow these steps for mounting your LED strips:

- The area where you are mounting the LEDs has to be clean: free of all dirt, oil or anything that might affect the LED from sticking. You only get one opportunity to mount the LEDs so it's critical the area be prepared properly.
- Use rubbing alcohol to clean the area where you are going to mount the LED strip. Be sure to let the alcohol dry completely before proceeding to the next step. (Note: Do not use acetone or similar cleaner).
- Next, use the 3M Adhesion Promoter supplied with your kit to "paint" on the promoter where you are going to mount the LED strip. ***This is an important step. Do not bypass.*** Allow the promoter to dry for 60-90 seconds.
- Peel off the red backing tape that protects the 3M adhesive tape on your LED strip. Be careful not to let the tape touch anything. The 3M backing tape on these LED strips are one-use only. They cannot be reused.

Do NOT bend the LED strip in a radius of less than 2 inches.



Do NOT bend the LED strip on a horizontal plane.



Carefully push the LED strip to the area you have prepared. You will want to apply only enough pressure to the strip to make sure it is firmly mounted. *You only get one opportunity to do this.* Once the LED strip touches a properly prepared surface that has been promoted, that LED strip will be very difficult to remove. Moreover, if you do remove the LED strip, the strip cannot be used again without adding another layer of 3M adhesive tape to the back. DO NOT press too hard as too much pressure can damage the LEDs and connecting wires in the strip. Also, do not pull, stretch or twist the LED strip. Too much tension on the strip will also damage the LEDs such that some of the LEDs in the strip will not illuminate. The strip must be mounted flat against a single continuous mounting surface, in a straight line. Really important that the ENTIRE STRIP be stuck to the mounting surface and that you NOT attempt to span across multiple mounting surfaces.

INSTALLATION

1. Remove the heat shield on each exhaust stack. There are 6 bolts (and lock washers with nuts) total for each stack.
2. Each stack will require 2 L-Channels to mount the LED strips. One on each side of the stack. We have photos showing the placement. One of the L-Channels is riveted to the shield bracket. The other L-Channel mounts using the existing shield bolt so you'll have a drill 3 holes in it where the heat shield bracket's line up. See photos starting on next page.
3. The L-Channel that's riveted to the stack mounting bracket is installed first. You can attach the LED strip to that L-Channel too after it's secured to the stack mounting brackets. We have a photo of this as well.
4. The L-Channel that's bolted using the existing heat shield mounting bolts should not be mounted until AFTER you've installed the LED strip to it. This is important because once that bracket is bolted to the truck, there isn't room to get your hands in to affix the LED strip to the L-Channel. See photo.
5. The power leads from each LED Strip will come together at the bottom of the stack. This is where you'll need to add the male side of the quick-disconnect. Both power leads will use the same quick-disconnect. The female side of the quick-disconnect will connect to the power lead going to your switch, power source or LED controller. Note: We have a photo that shows how to wire the quick-disconnects for this kit and use heat shrink.
6. Determine how you're going to run the power lead that attaches to the LED strip from each stack. We usually run it under the truck over to the battery box but there are other options too. However you run it, it's important that the power leads be wrapped in split loom AND they're not touching or too close to the exhaust stack. Use zip ties to secure the power lead so it can't touch the exhaust stack.
7. Connect the power lead to your power source, switch or LED controller. If you have another Boogey Lights LED kit installed (e.g. under-glow, grill, etc) you can connect the power leads to that kit too.

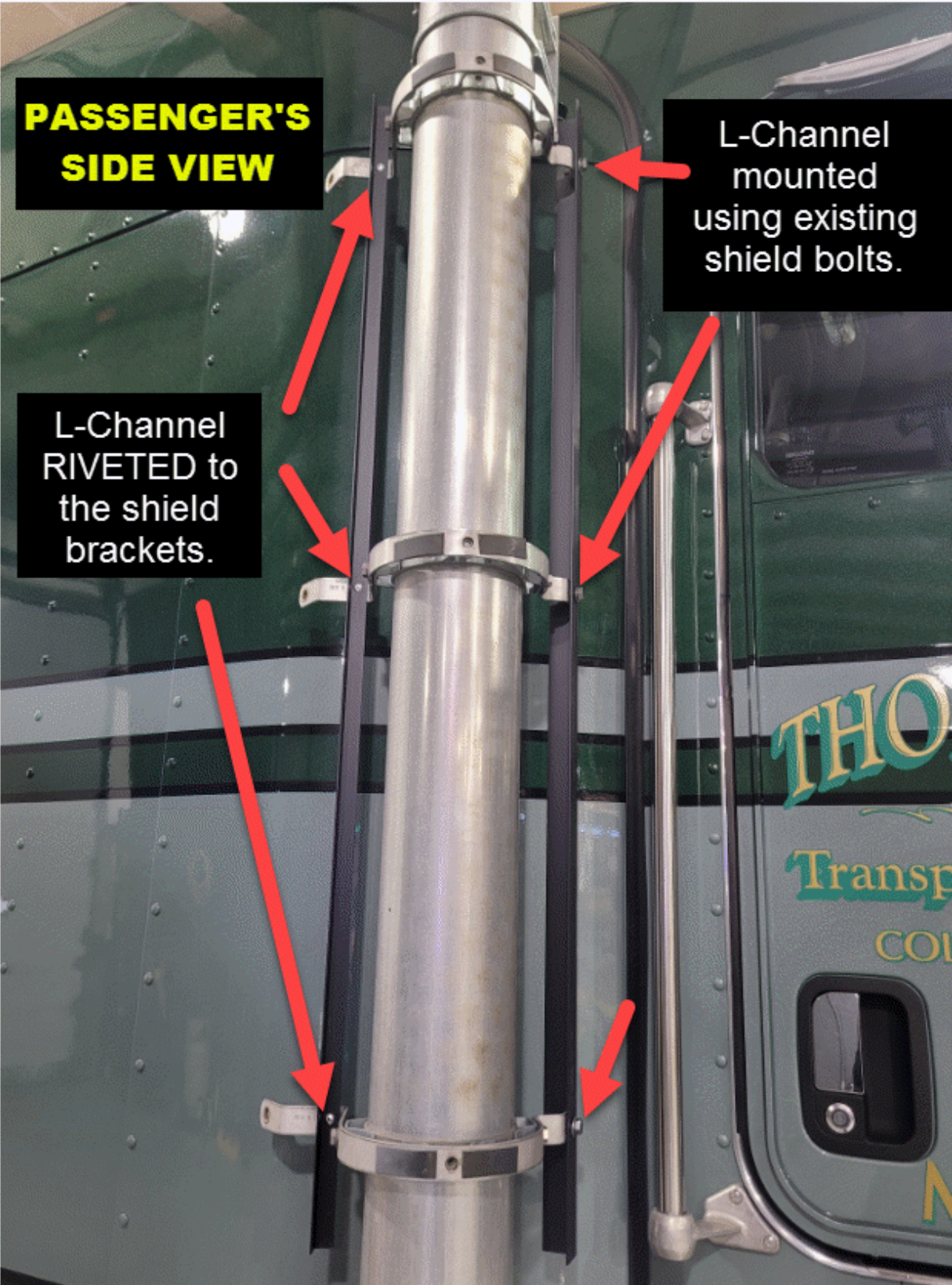

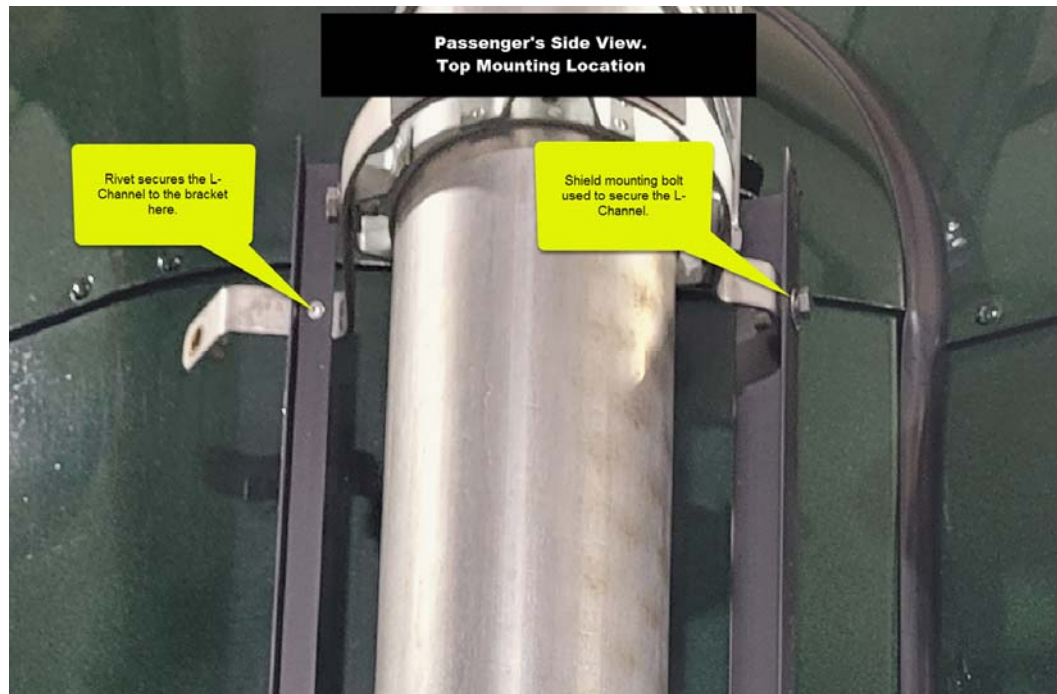
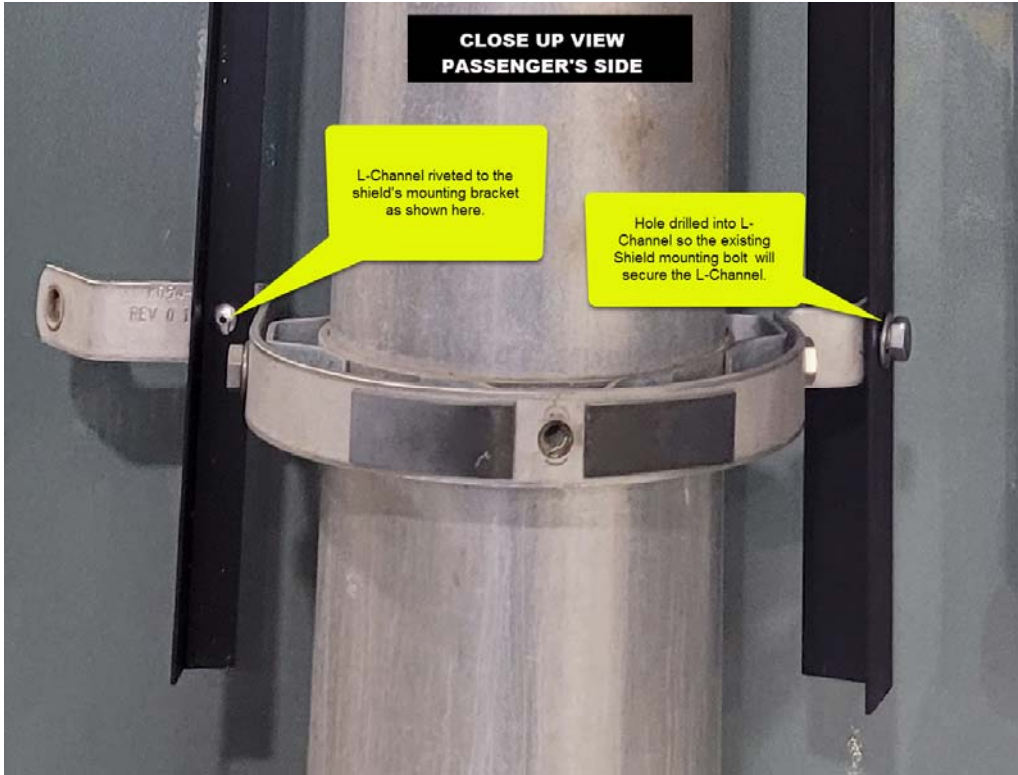

8.

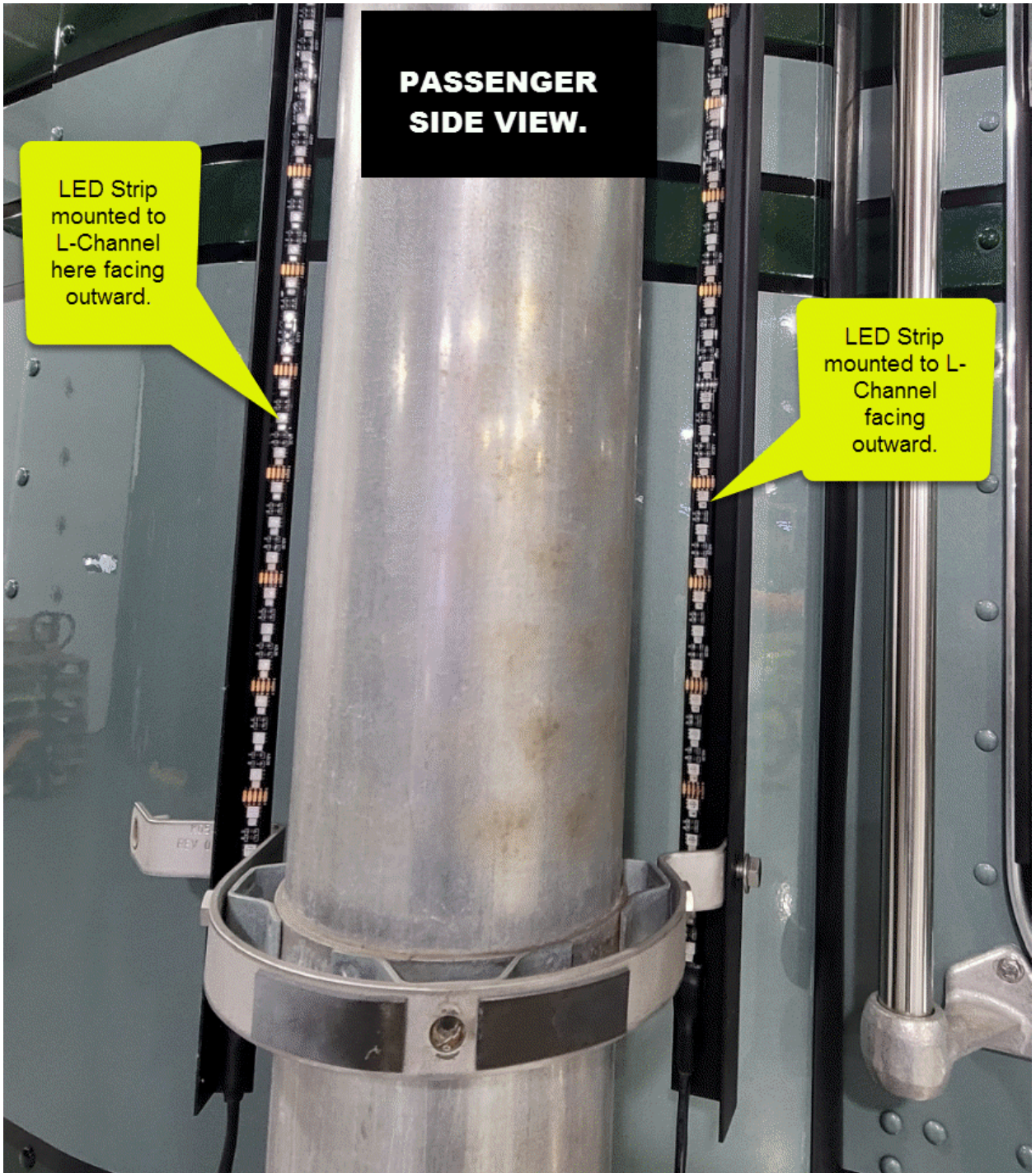

**PASSENGER
SIDE VIEW.**

LED Strip
mounted to
L-Channel
here facing
outward.

LED Strip
mounted to L-
Channel
facing
outward.

9.



10.

Passenger's Side View with the Shield Re-Attached

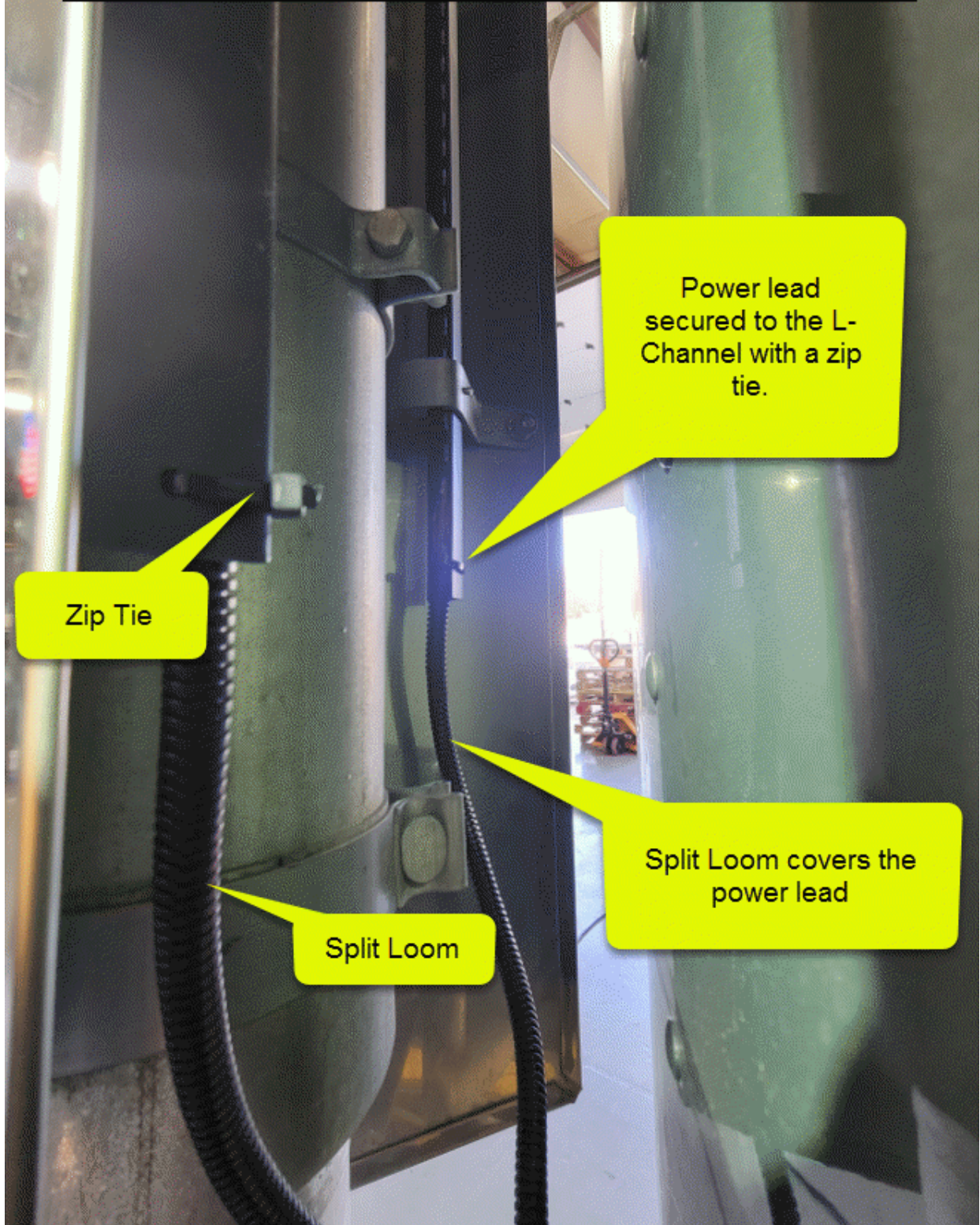

11.

Adding the Quick-Disconnect

Twist the wires together tightly then slide the 1/8" heat shrink over the connection. Heat shrink that connection. Repeat for the other 3 power leads.

When done, slide the 1/2" heat shrink over the entire connection and seal.

